

# AGI Reaction Unit controlled by RX-10

Chemical Synthesis  
Crystallization  
Hydrogenation

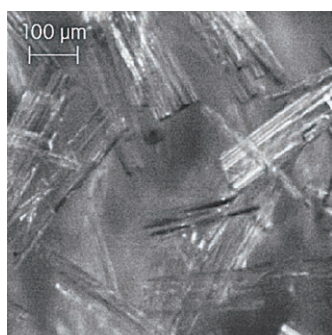

**METTLER TOLEDO**  
Partnered with **AGI!**  
[www.mt-agi.com](http://www.mt-agi.com)



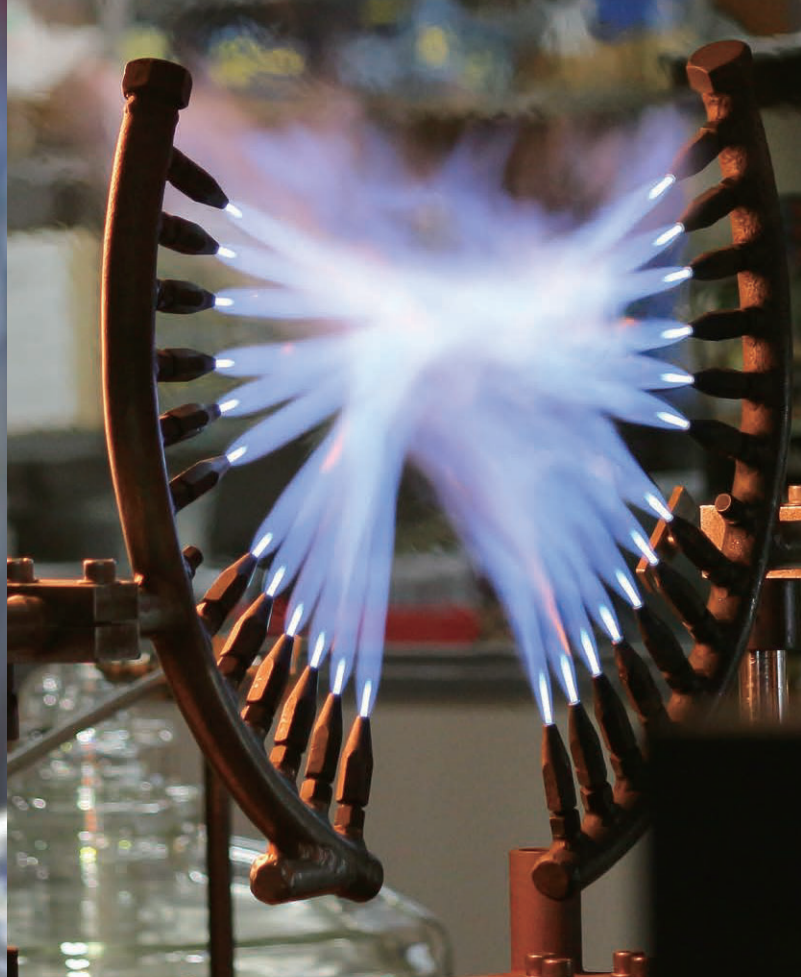

AG! started out processing laboratory glassware and have grown into a complete, all-round glass manufacturer. With glass as our focus from the start, we are proud of our expertise and relationships with our customers we have gained along the way.







In addition to our standard products, we also manufacture custom-made items and glass parts for use with analyzing equipment. In addition to simply producing glassware, we also design and develop new equipment.



## A Strategic Partnership

To further serve our customers better, we have decided to establish a strategic partnership with Asahi Glassplant Inc., AGI, to provide our customers the possibility to have their system glassware sourced directly from a world-class glass company. This will provide you with a smoothness integration and allows us to deliver faster and better services such as responding to special system requests. We are looking forward to further provide you with excellent services.

**METTLER TOLEDO**

**METTLER TOLEDO**  
Partnered with **AGI!**  
[www.mt-agi.com](http://www.mt-agi.com)

### **METTLER TOLEDO Group**

Automated Reactors and In Situ Analysis  
Local contact: [www.mt.com/contacts](http://www.mt.com/contacts)

Subject to technical changes  
© 09/2017 METTLER TOLEDO. All rights reserved

### **Asahi Glassplant Inc.**

[www.agi.co.jp](http://www.agi.co.jp)

4	<b>Table of Contents</b>
5 – 28	<b>Chemical Synthesis, Crystallization</b>
5	AGI Reaction Unit controlled by RX-10 – Chemical Synthesis, Crystallization
6 – 7	Chemical Synthesis Unit
8 – 9	Chemical Synthesis Unit with Accessories
10 – 11	Crystallization Unit
12 – 13	Crystallization Unit with Accessories
14 – 15	AGI Proprietary Ring Baffle Technology
16 – 17	PTFE Reactor Covers
18	Glass Reactor – Double Wall, Triple Wall
19	O Ring, Clamp – For Glass Reactor
20	Stoppers – For Reactor Covers
21	Standard Taper Joint Adapters – For PTFE Covers and Reducing Adapters Adapters – For Probe Sensors
22	Flush Valve
23 – 24	Reflux Condenser
24	Dosing Adapter
25	SQG Adapters – For PTFE Reactor Covers Universal Stirrer Guide
26	Stand – For Glass Reactor
27	Temperature Sensor and Metal Adapter Insulated Flexible Hose
28	PTFE Stirrers
29 – 33	<b>Hydrogeneration</b>
29	AGI Reaction Unit controlled by RX-10 – Hydrogeneration Unit
30 – 31	Hydrogeneration Unit
32	Pressure Reactor
33	O ring, Metal Adapter, Thermostat – For Pressure Reactor
34 – 49	<b>Connecting Apparatuses</b>
34	Connecting Sensors, Dosing Devices and Analytics
35 – 36	RX-10™ – Reactor Control and Data Capture
37 – 38	Sampling, inline Analytics and Measurement
39 – 45	ECB™ – Easy Control Box – Sensors and Controlled Dosing
46 – 47	SevenExcellence™ for RX-10 – pH/mV Measurement Equipment
48	iControl™ Software – For RX-10
49	iC Data Center™ – Capture, Prepare, Share
50 – 51	<b>AGI Lineup</b>
50	Reaction Unit Filter Reactor Short Path Evaporator Rotary Evaporator
51	Nutsche Filter Thin Film Evaporator

# AGI Reaction Unit controlled by RX-10

## Chemical Synthesis, Crystallization



<http://bit.ly/2N5yP8u>



※PTFE Cover is Standard

### Bench-top Reactor

### Chemical Synthesis Unit Crystallization Unit

Vessel Capacity : 3000, 5000 mL

Vessel Type : Double Wall (Thermal Jacket)

Triple Wall (Thermal Jacket and Vacuum Jacket)

Operating Pressure : Full Vacuum to atm

Operating Jacket Pressure : Up to +0.5 bar G (+0.05 MPa)

Operating Temperature : -90 °C to +230 °C

$\Delta T$  : 110 °C (Double Wall), 60°C (Triple Wall)

This system does not include overhead stirrer, circulator and chiller.

Please contact us about customized systems.

# Chemical Synthesis Unit

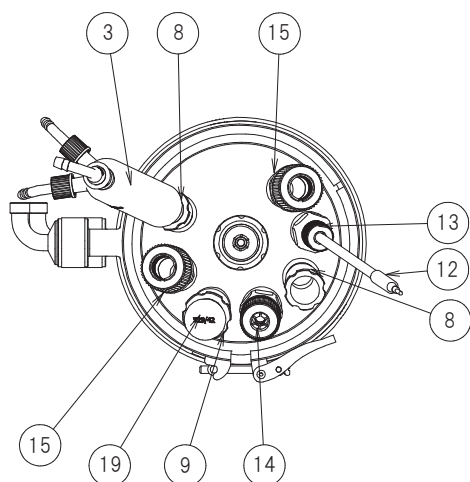

Chemical Synthesis Unit : Top

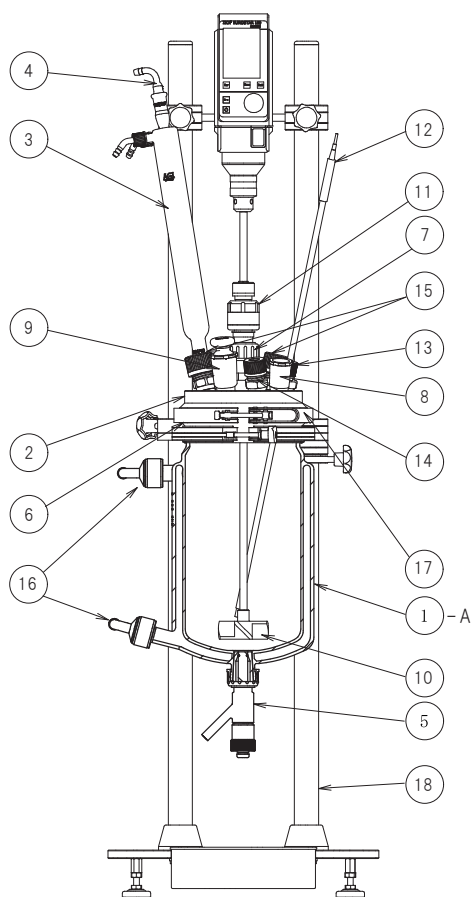

Chemical Synthesis Unit : Front  
Double Wall Reactor

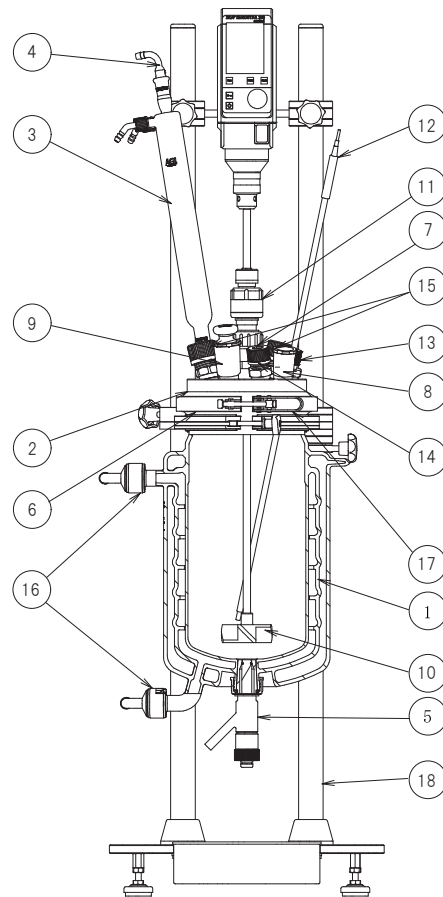

Chemical Synthesis Unit : Front  
Triple Wall Reactor



## Chemical Synthesis unit Triple Wall DN150

Order Number	Product Description	Quantity
<b>5790-3000</b>	3000 mL Chemical Synthesis unit	1
<b>5790-5000</b>	5000 mL Chemical Synthesis unit	1

## Chemical Synthesis unit Double Wall DN150

Order Number	Product Description	Quantity
<b>5791-3000</b>	3000 mL Chemical Synthesis unit	1
<b>5791-5000</b>	5000 mL Chemical Synthesis unit	1

## Chemical Synthesis unit consisting of

Number	Order Number	Product Description	3000 mL	5000 mL	Quantity	Page
①	<b>5742M00005</b>	3000mL Glass reactor Triple Wall with Ring baffle DN150	●		1	18
	<b>5742M00006</b>	5000mL Glass reactor Triple Wall with Ring baffle DN150		●	1	18
① - A	<b>5712M00005</b>	3000mL Glass reactor Double Wall with Ring baffle DN150	●		1	18
	<b>5712M00006</b>	5000mL Glass reactor Double Wall with Ring baffle DN150		●	1	18
②	<b>5798P00001</b>	PTFE cover for reactor, 8ports	●	●	1	16
③	<b>3442-300W-4L1L</b>	Reflux Condenser, ST24/40	●	●	1	23
④	<b>2402-1L</b>	Exhaust Pipe,bended, ST15/25	●	●	1	23
⑤	<b>3960-01T</b>	Flush Valve, SQG-29/42	●	●	1	22
⑥	<b>9260R00006</b>	O Ring for DN150	●	●	1	19
⑦	<b>5702P00003</b>	Compression Screw Fittings, SQG29/42	●	●	1	25
⑧	<b>MT30215733</b>	Taper joint adapter 3/4" NPT ST24/40	●	●	2	21
⑨	<b>MT30245674</b>	Taper joint adapter 3/4" NPT ST29/42	●	●	1	21
⑩	<b>3365P-10/70/650</b>	Stirrer Shaft, Pitched Paddle type	●	●	1	28
⑪	<b>3341-5L-10</b>	Universal Stirrer Guide, SQG-29/42	●	●	1	25
⑫	<b>3381-600</b>	Temperature Sensor	●	●	1	27
⑬	<b>MT30245680</b>	Compression Fitting 3/4" NPT, Ø 8	●	●	1	21
⑭	<b>MT30245700</b>	Compression Fitting 3/4" NPT, 3/8"	●	●	1	21
⑮	<b>MT5702P00008</b>	Compression Fitting 3/4" NPT, Ø 19	●	●	2	21
⑯	<b>9199L00001</b>	Metal Adaptor	●	●	2	27
⑰	<b>3966-150</b>	Clamp	●	●	1	19
⑱	<b>5750000001</b>	Stand : DN150	●	●	1	26
⑲	<b>2242-29/42</b>	Flat Head Glass stopper ST29/42	●	●	1	20

\* Overhead stirrer motor is not included

# Chemical Synthesis Unit with Accessories

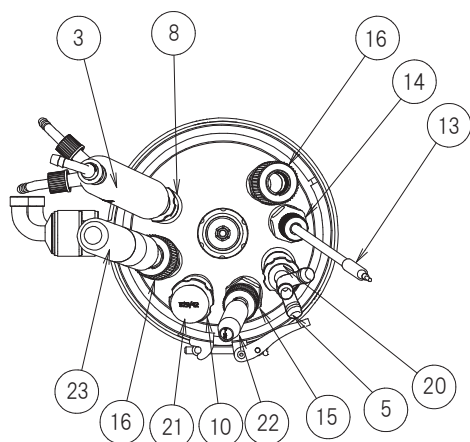

Chemical Synthesis Unit : Top

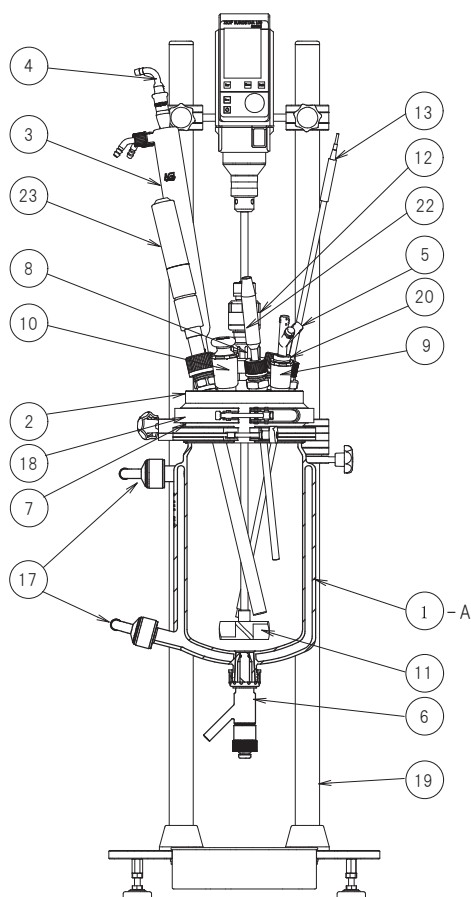
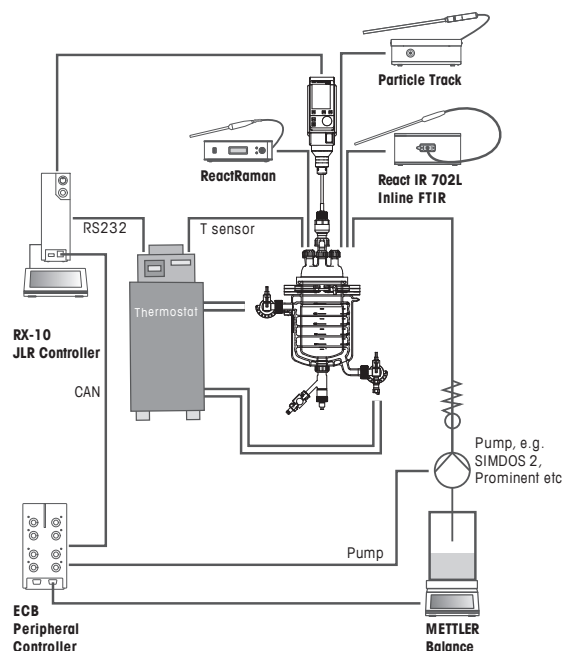

Chemical Synthesis Unit : Front  
Double Wall Reactor

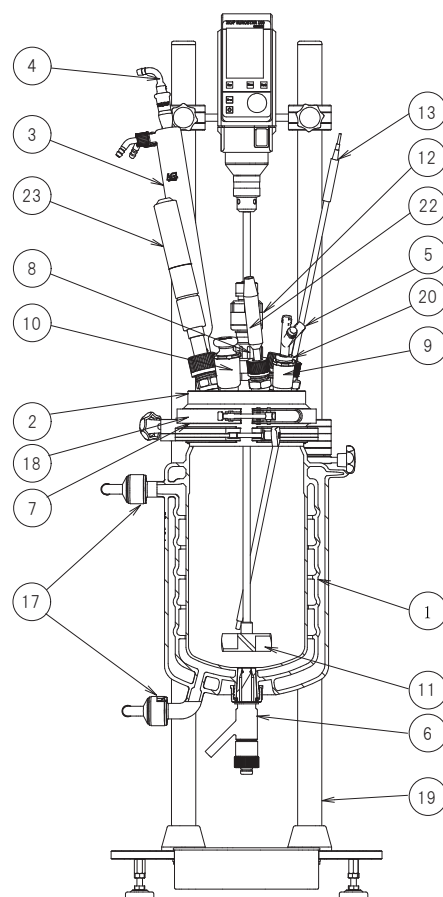

Chemical Synthesis Unit : Front  
Triple Wall Reactor



## Chemical Synthesis unit Triple Wall DN150

Order Number	Product Description	Quantity
<b>5792-3000</b>	3000 mL Chemical Synthesis unit for Accessories	1
<b>5792-5000</b>	5000 mL Chemical Synthesis unit for Accessories	1

## Chemical Synthesis unit Double Wall DN150

Order Number	Product Description	Quantity
<b>5793-3000</b>	3000 mL Chemical Synthesis unit for Accessories	1
<b>5793-5000</b>	5000 mL Chemical Synthesis unit for Accessories	1

## Chemical Synthesis unit for Accessories consisting of

Number	Order Number	Product Description	3000 mL	5000 mL	Quantity	Page
①	<b>5742M00005</b>	3000mL Glass reactor Triple Wall with Ring baffle DN150	●		1	18
	<b>5742M00006</b>	5000mL Glass reactor Triple Wall with Ring baffle DN150		●	1	18
① – A	<b>5712M00005</b>	3000mL Glass reactor Double Wall with Ring baffle DN150	●		1	18
	<b>5712M00006</b>	5000mL Glass reactor Double Wall with Ring baffle DN150		●	1	18
②	<b>5798P00001</b>	PTFE cover for reactor, 8ports	●	●	1	16
③	<b>3442-300W-4L1L</b>	Reflux Condenser, ST24/40	●	●	1	23
④	<b>2402-1L</b>	Exhaust Pipe,bended, ST15/25	●	●	1	23
⑤	<b>MT51161834</b>	3-Way Dosing Adapter Set	●	●	1	24
⑥	<b>3960-01T</b>	Flush Valve, SQG-29/42	●	●	1	22
⑦	<b>9260R00006</b>	O Ring for DN150	●	●	1	19
⑧	<b>5702P00003</b>	Compression Screw Fittings, SQG29/42	●	●	1	25
⑨	<b>MT30215733</b>	Taper joint adapter 3/4" NPT ST24/40	●	●	2	21
⑩	<b>MT30245674</b>	Taper joint adapter 3/4" NPT ST29/42	●	●	1	21
⑪	<b>3365P-10/70/650</b>	Stirrer Shaft, Pitched Paddle type	●	●	1	28
⑫	<b>3341-5L-10</b>	Universal Stirrer Guide, SQG-29/42	●	●	1	25
⑬	<b>3381-600</b>	Temperature Sensor	●	●	1	27
⑭	<b>MT30245680</b>	Compression Fitting 3/4" NPT, Ø 8	●	●	1	21
⑮	<b>MT30245700</b>	Compression Fitting 3/4" NPT, 3/8"	●	●	1	21
⑯	<b>MT5702P00008</b>	Compression Fitting 3/4" NPT, Ø 19	●	●	2	21
⑰	<b>9199L00001</b>	Metal Adaptor	●	●	2	27
⑱	<b>3966-150</b>	Clamp	●	●	1	19
⑲	<b>5750000001</b>	Stand : DN 150	●	●	1	26
⑳	<b>2304-14/234L</b>	Reducing Adapter ST-14/23 to ST24/40	●	●	1	24
㉑	<b>2242-29/42</b>	Flat Head Glass stopper ST29/42	●	●	1	20

\* Overhead stirrer motor is not included

## RX-10

Order Number	Product Description	Quantity	Page
<b>30208790</b>	RX-10 units	1	35

## ECB

Order Number	Product Description	Quantity	Page
<b>30212440</b>	ECB set	1	39

## Balance

Order Number	Product Description	Quantity	Page
<b>30243431</b>	ML6001T/A00	1	38

## KNF SIMDOS

Order Number	Product Description	Quantity	Page
<b>30335504</b>	KNF SIMDOS 02 FT.18 RC-X	1	41

Order Number	Product Description	Quantity	Page
<b>30335503</b>	KNF SIMDOS 10 FT.18 RC-X	1	41

## Connecting Sensors and Analytics

Number	Order Number	Product Description	Quantity	Page
⑳	<b>30456495</b>	ReactIR 702L	1	37
㉑	<b>14420890</b>	ParticleTrack G400	1	37
㉒	<b>30248120</b>	InLab Reach 425 Needed items: Compression Fitting $\phi$ 12 mm <b>MT30245681</b>	1	47
㉓	<b>304725451</b>	ReactRaman 785 Needed items: Compression Fitting $\phi$ 1/2" <b>MT5702P00011</b>	1	37

# Crystallization Unit

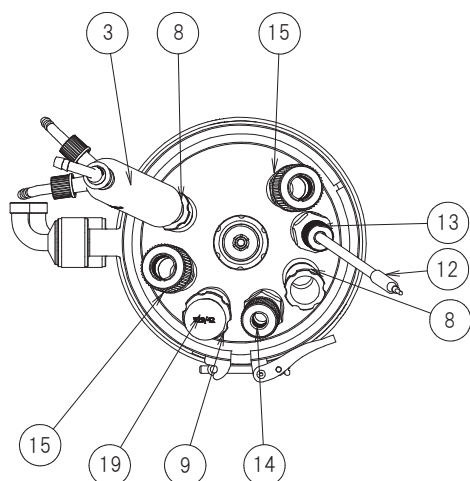

Crystallization Unit : Top

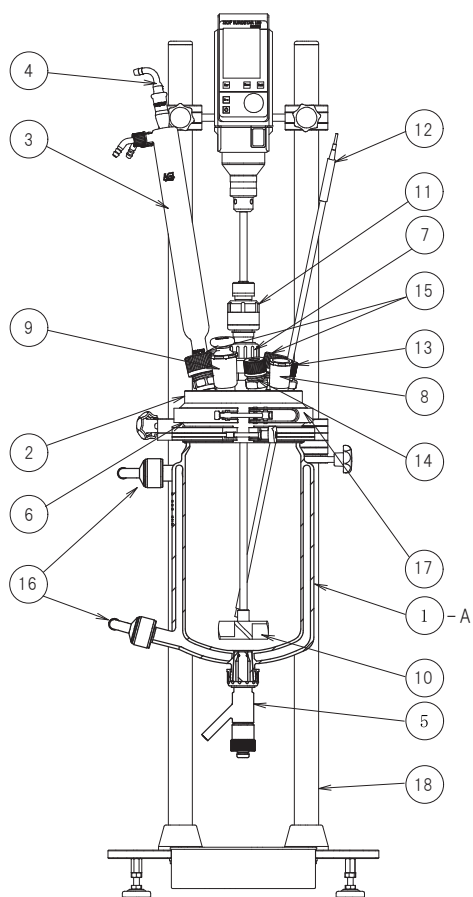

Crystallization Unit : Front  
Double Wall Reactor

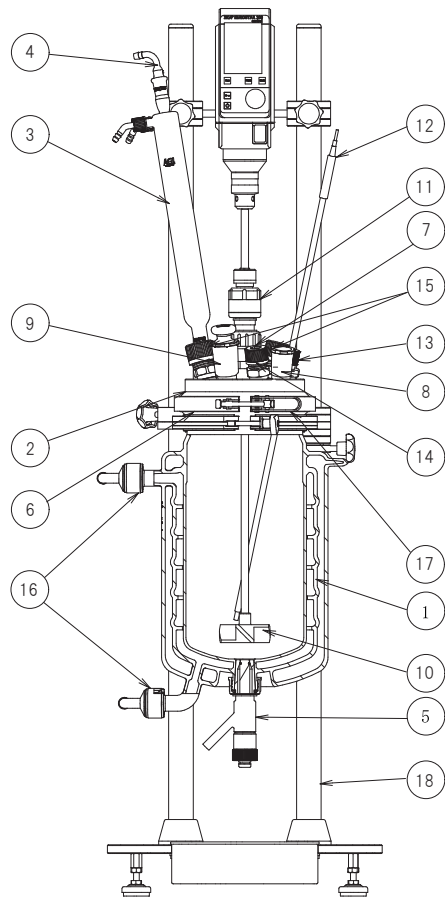

Crystallization Unit : Front  
Triple Wall Reactor

## Crystallization Unit Triple Wall DN150

Order Number	Product Description	Quantity
<b>5794-3000</b>	3000 mL Crystallization Unit	1
<b>5794-5000</b>	5000 mL Crystallization Unit	1

## Crystallization Unit Double Wall DN150

Order Number	Product Description	Quantity
<b>5795-3000</b>	3000 mL Crystallization Unit	1
<b>5795-5000</b>	5000 mL Crystallization Unit	1

## Crystallization unit consisting of

Number	Order Number	Product Description	3000 mL	5000 mL	Quantity	Page
①	<b>5742M00005</b>	3000mL Glass reactor Triple Wall with Ring baffle DN150	●		1	18
	<b>5742M00006</b>	5000mL Glass reactor Triple Wall with Ring baffle DN150		●	1	18
① - A	<b>5712M00005</b>	3000mL Glass reactor Double Wall with Ring baffle DN150	●		1	18
	<b>5712M00006</b>	5000mL Glass reactor Double Wall with Ring baffle DN150		●	1	18
②	<b>5799P00001</b>	PTFE cover for reactor, 8ports	●	●	1	17
③	<b>3442-300W-4L1L</b>	Reflux Condenser, ST24/40	●	●	1	23
④	<b>2402-1L</b>	Exhaust Pipe,bended, ST15/25	●	●	1	23
⑤	<b>3960-01T</b>	Flush Valve, SQG-29/42	●	●	1	22
⑥	<b>9260R00006</b>	O Ring for DN150	●	●	1	19
⑦	<b>5702P00003</b>	Compression Screw Fittings, SQG29/42	●	●	1	25
⑧	<b>MT30215733</b>	Taper joint adapter 3/4" NPT ST24/40	●	●	2	21
⑨	<b>MT30245674</b>	Taper joint adapter 3/4" NPT ST29/42	●	●	1	21
⑩	<b>3365P-10/70/650</b>	Stirrer Shaft, Pitched Paddle type	●	●	1	28
⑪	<b>3341-5L-10</b>	Universal Stirrer Guide, SQG-29/42	●	●	1	25
⑫	<b>3381-600</b>	Temperature Sensor	●	●	1	27
⑬	<b>MT30245680</b>	Compression Fitting 3/4" NPT, Ø 8	●	●	1	21
⑭	<b>MT30245681</b>	Compression Fitting 3/4" NPT, Ø 12	●	●	1	21
⑮	<b>MT5702P00008</b>	Compression Fitting 3/4" NPT, Ø 19	●	●	2	21
⑯	<b>9199L00001</b>	Metal Adaptor	●	●	2	27
⑰	<b>3966-150</b>	Clamp	●	●	1	19
⑱	<b>5750000001</b>	Stand : DN150	●	●	1	26
⑲	<b>2242-29/42</b>	Flat Head Glass stopper ST29/42	●	●	1	20

\* Overhead stirrer motor is not included



# Crystallization Unit with Accessories

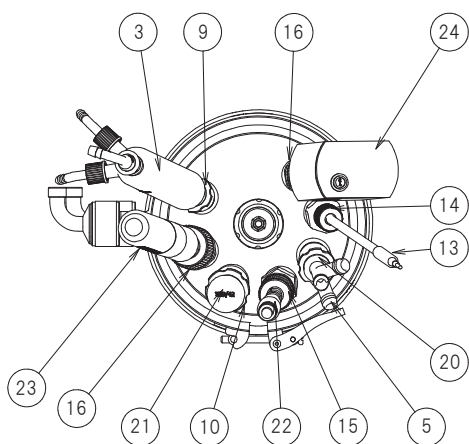

Crystallization : Top

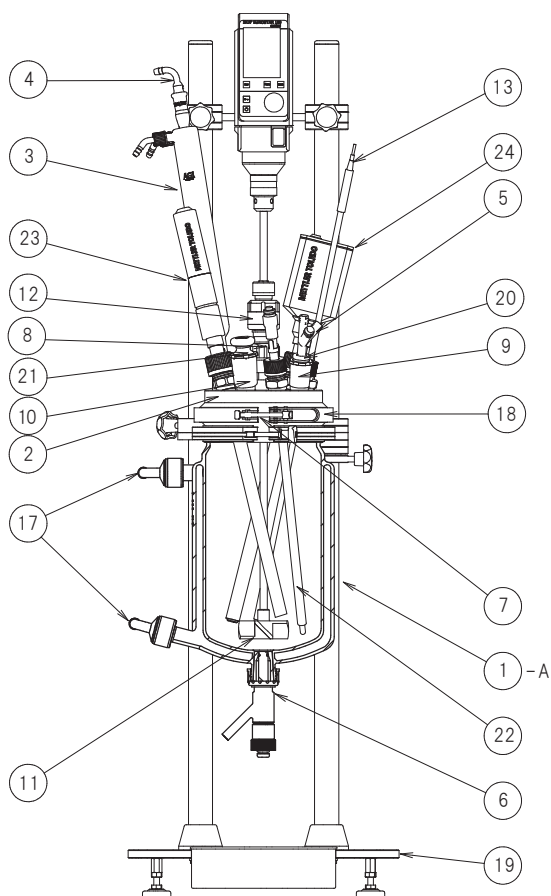
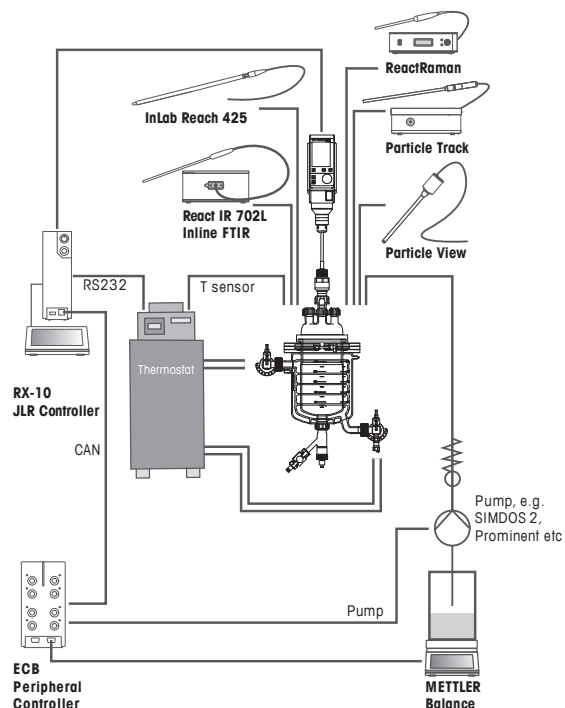

Crystallization : Front  
Double Wall Reactor

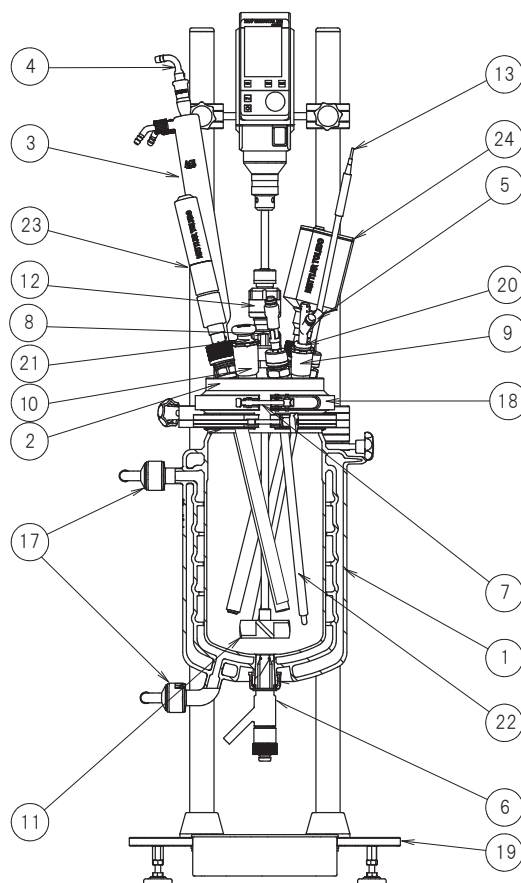

Crystallization : Front  
Triple Wall Reactor

## Crystallization Unit Triple Wall DN150

Order Number	Product Description	Quantity
<b>5796-3000</b>	3000 mL Crystallization Unit for Accessories	1
<b>5796-5000</b>	5000 mL Crystallization Unit for Accessories	1

## Crystallization Unit Double Wall DN150

Order Number	Product Description	Quantity
<b>5797-3000</b>	3000 mL Crystallization Unit for Accessories	1
<b>5797-5000</b>	5000 mL Crystallization Unit for Accessories	1

## Crystallization unit set for Accessories consisting of

Number	Order Number	Product Description	3000 mL	5000 mL	Quantity	Page
①	<b>5742M00005</b>	3000mL Glass reactor Triple Wall with Ring baffle DN150	●		1	18
	<b>5742M00006</b>	5000mL Glass reactor Triple Wall with Ring baffle DN150		●	1	18
① – A	<b>5712M00005</b>	3000mL Glass reactor Double Wall with Ring baffle DN150	●		1	18
	<b>5712M00006</b>	5000mL Glass reactor Double Wall with Ring baffle DN150		●	1	18
②	<b>5799P00001</b>	PTFE cover for reactor, 8ports	●	●	1	17
③	<b>3442-300W-4L1L</b>	Reflux Condenser, ST24/40	●	●	1	23
④	<b>2402-1L</b>	Exhaust Pipe,bended, ST15/25	●	●	1	23
⑤	<b>MT51161834</b>	3-Way Dosing Adapter Set	●	●	1	24
⑥	<b>3960-01T</b>	Flush Valve, SQG-29/42	●	●	1	22
⑦	<b>9260R00006</b>	O Ring for DN150	●	●	1	19
⑧	<b>5702P00003</b>	Compression Screw Fittings, SQG29/42	●	●	1	25
⑨	<b>MT30215733</b>	Taper joint adapter 3/4" NPT ST24/40	●	●	2	21
⑩	<b>MT30245674</b>	Taper joint adapter 3/4" NPT ST29/42	●	●	1	21
⑪	<b>3365P-10/70/650</b>	Stirrer Shaft, Pitched Paddle type	●	●	1	28
⑫	<b>3341-5L-10</b>	Universal Stirrer Guide, SQG-29/42	●	●	1	25
⑬	<b>3381-600</b>	Temperature Sensor	●	●	1	27
⑭	<b>MT30245680</b>	Compression Fitting 3/4" NPT, Ø 8	●	●	1	21
⑮	<b>MT30245681</b>	Compression Fitting 3/4" NPT, Ø 12	●	●	1	21
⑯	<b>MT5702P00008</b>	Compression Fitting 3/4" NPT, Ø 19	●	●	2	21
⑰	<b>9199L00001</b>	Metal Adaptor	●	●	2	27
⑱	<b>3966-150</b>	Clamp	●	●	1	19
⑲	<b>5750000001</b>	Stand : DN 150	●	●	1	26
⑳	<b>2304-14/234L</b>	Reducing Adapter ST-14/23 to ST24/40	●	●	1	24
㉑	<b>2242-29/42</b>	Flat Head Glass stopper ST29/42	●	●	1	20

\* Overhead stirrer motor is not included

## RX-10

Order Number	Product Description	Quantity	Page
<b>30208790</b>	RX-10 units	1	35

## ECB

Order Number	Product Description	Quantity	Page
<b>30212440</b>	ECB set	1	39

## Balance

Order Number	Product Description	Quantity	Page
<b>30243431</b>	ML6001T/A00	1	38

## KNF SIMDOS

Order Number	Product Description	Quantity	Page
<b>30335504</b>	KNF SIMDOS 02 FT.18 RC-X	1	41

Order Number	Product Description	Quantity	Page
<b>30335503</b>	KNF SIMDOS 10 FT.18 RC-X	1	41

## Connecting Sensors and Analytics

Number	Order Number	Product Description	Quantity	Page
⑳	30248120	InLab Reach 425	1	47
㉑	14420890	ParticleTrack G400	1	37
㉒	14000031	ParticleView V19	1	37
㉓	30456495	ReactIR 702L    Needed items: Compression Fitting $\phi$ 3/8"    MT30245700	1	37
㉔	304725451	ReactRaman 785    Needed items: Compression Fitting $\phi$ 1/2"    MT5702P00011	1	37

## Uniquely Engineered for Precise Temperature Control

Our Proprietary Ring Baffle Technology forces the thermal fluid in a specific "path" to ensure equal heat distribution while maximizing the working surface area promoting even heat transfer by providing rapid temperature recovery due to endothermic or exothermic reactions quickly and efficiently while maximizing the energy provided by the temperature control unit.

Only AG! offers this advanced design for all our glass reactors.







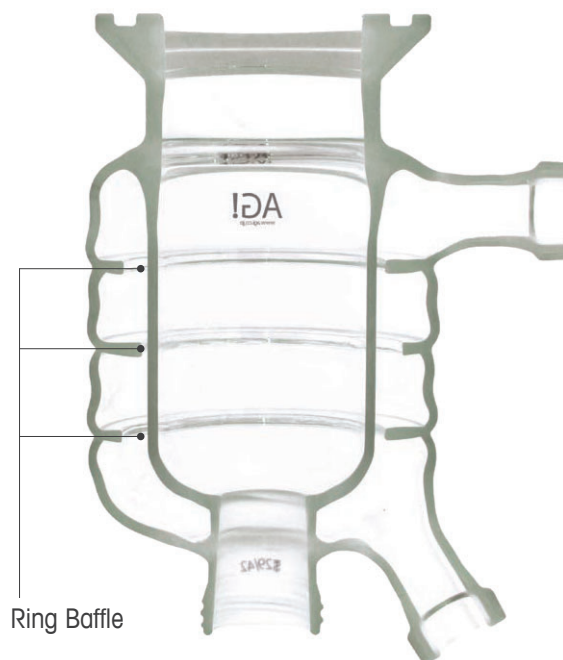



## Less Time and More Productivity

Precise and uniform temperature control will improve productivity by decreasing process times while increasing higher yields and reducing your operating costs in your process.

## AG! Proprietary Ring Baffle Technology



## Precise Temperature Process Control with Integrated Glass Ring Baffle Technology

AG! Jacketed Ring Baffle Technology						<p>AG! Glass Ring Baffle Technology Benefits:</p> <p>The AG! design maximizes the heat transfer area</p> <ul style="list-style-type: none"> <li>• Integrated full jacket design</li> <li>• Optimal heat transfer</li> <li>• Eliminates hot/cold zones</li> <li>• Maximizes the energy of the TCU</li> </ul>
	Heat Transfer Fluid In					
Standard Jacketed Vessel						<p>◀ Hot / Cold Zones</p>

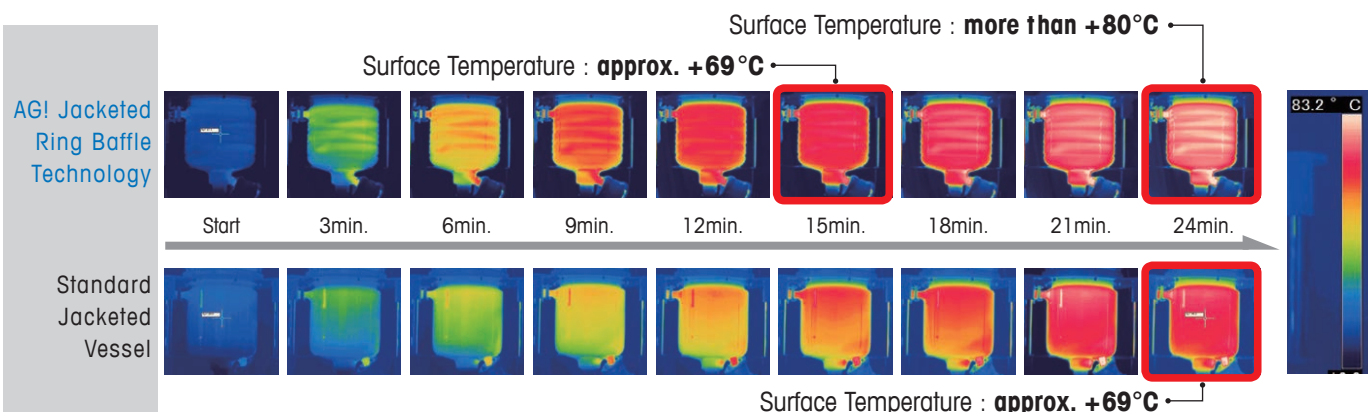



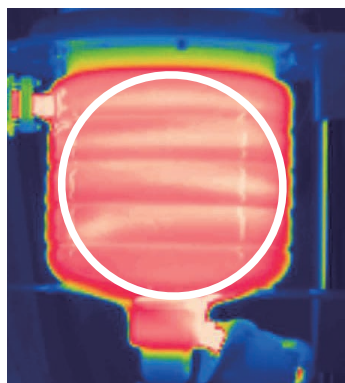

even thermal distribution (HTF)  
<AG! Vessel with Ring Baffle>

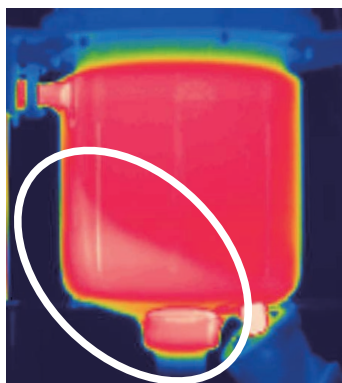

localized heating  
<Standard Jacketed Vessel>

## Even Heating / Cooling

AG! Glass Ring Baffle prevents 'Short-path' of HTF.

- Optimizes the Heat Transfer to the Internal Vessel
- Uniform and Efficient Temperature Stability

## Time to Temperature Study

### Case Study 1

Comparison:

**AG! Double Wall Ring Baffle 1L Reactor**

vs.

**AG! Double Wall 1L Reactor**

[ Terms of Exam ] Thermostat: LAUDA RP890C, HTF: Silicone Oil

**Result 30 minutes of Time Saving**

Note. Double Wall Ring Baffle 1L Reactor: 51.4min. vs. Double Wall 1L Reactor: 83.1min.

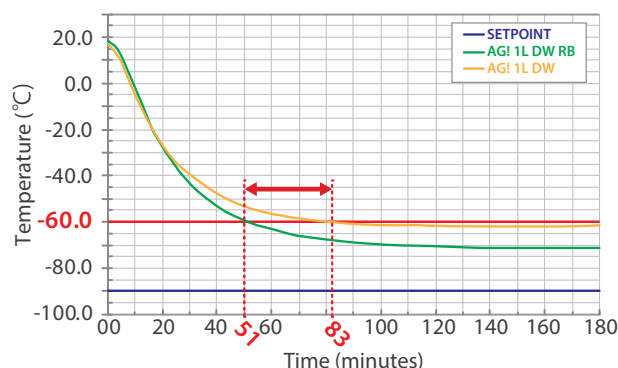

### Case Study 2

Comparison:

**AG! Triple Wall Ring Baffle 60L Reactor**

vs.

**Competitor Standard Double Wall; Jacketed 50L Reactor**

[ Terms of Exam ] Thermostat: HUBER Unistat 510w, HTF: Silicone Oil

**Result 120 minutes of Time Saving**

Note. AG! : 230min. vs. Other : 350min. (-49°C)

AG! Advantage:

**Competitor reactor did not achieve the targeted temperature (-50°C); 10L difference in reactor volumes**

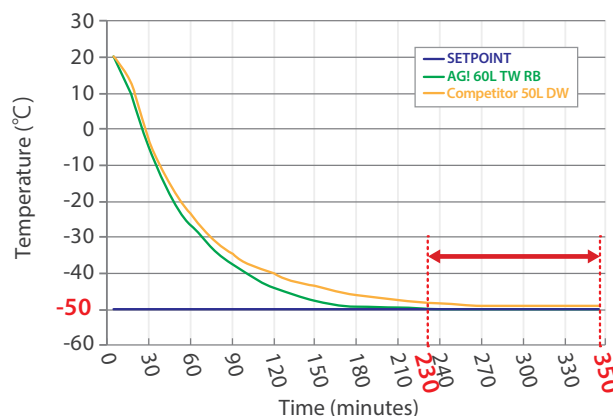

### Case Study 3

Comparison:

**AG! Triple Wall Ring Baffle 20L Reactor**

vs.

**Competitor Standard Double Wall; Jacketed 10L Reactor**

[ Terms of Exam ] Thermostat: JULABO PRESTO A40, HTF: Silicone Oil

**Result 75 mins. to temp; 10L volume difference**

Note. AG! : 75min. vs. Competitor: 75min.

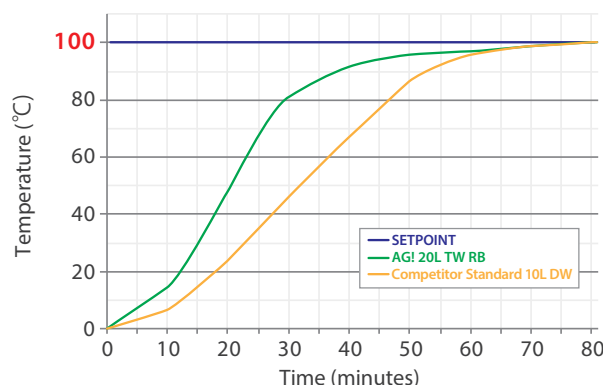

# PTFE Reactor Covers

## 3000,5000 mL PTFE reactor cover Chemical Synthesis

● ————— SQG29/42

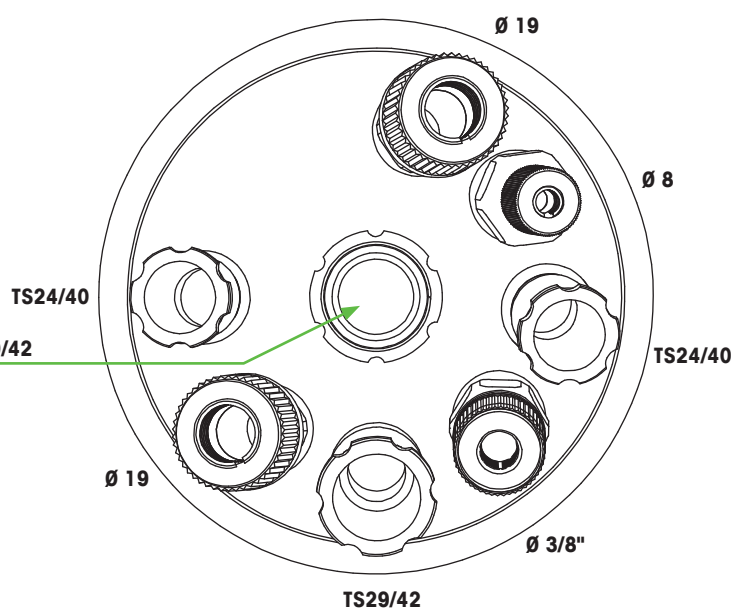

<b>5798P00001</b>	<b>PTFE cover for reactor, 8ports</b>
	2 x TS24/40, 1 x TS29/42, center SQG29/42 1 x Ø 8.0, 2 x Ø 19.0, 1 x Ø 3/8"
Material	PTFE
Temperature	–90 °C to 200 °C
Size	Inner Ø 150 mm
Quantity	1

**3000,5000 mL PTFE reactor cover**

Crystallisation

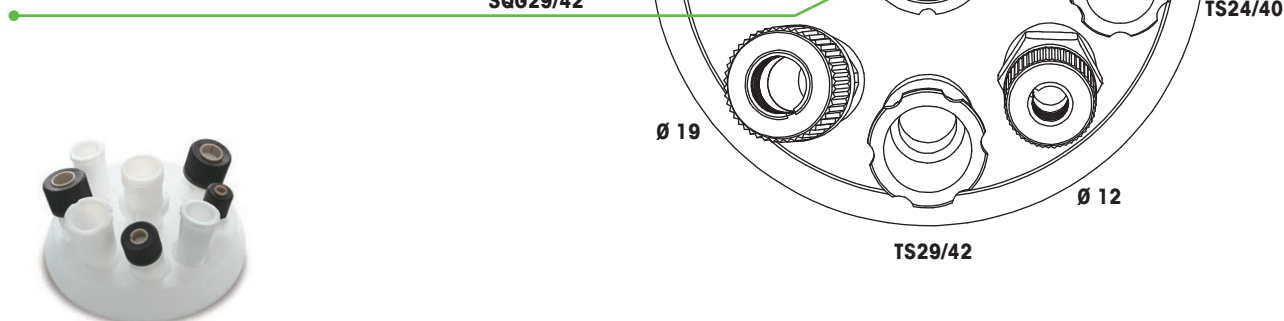
**5799P00001****PTFE cover for reactor, 8ports**

2 x TS24/40, 1 x TS29/42, center SQG29/42

1 x Ø 8.0, 2 x Ø 19.0, 1 x Ø 12.0

Material

PTFE

Temperature

-90 °C to 200 °C

Size

Inner Ø 150 mm

Quantity

1

**3000, 5000 mL PTFE reactor cover**

Base Cover

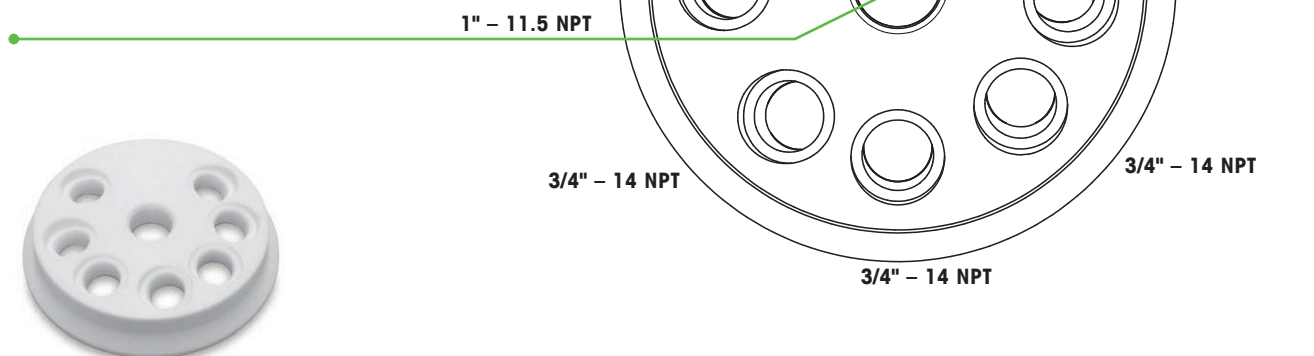
**5702P00009****PTFE cover for reactor, 8ports**

7 x 3/4" - 14 NPT, center 1" - 11.5 NPT

Material

PTFE

Temperature

-90 °C to 200 °C

Size

Inner Ø 150 mm

Quantity

1



# Glass Reactor

## Double Wall, Triple Wall



<b>5712M00005</b>	<b>3000mL Glass reactor Double Wall with Ring baffle DN150</b>
Material	Borosilicate glass
Working volume	3000mL
Temperature	-90 °C to + 230 °C
Quantity	1



<b>5742M00005</b>	<b>3000mL Glass reactor Triple Wall with Ring baffle DN150</b>
Material	Borosilicate glass
Working volume	3000mL
Temperature	-90 °C to + 230 °C
Quantity	1



<b>5712M00006</b>	<b>5000mL Glass reactor Double Wall with Ring baffle DN150</b>
Material	Borosilicate glass
Working volume	5000mL
Temperature	-90 °C to + 230 °C
Quantity	1



<b>5742M00006</b>	<b>5000mL Glass reactor Triple Wall with Ring baffle DN150</b>
Material	Borosilicate glass
Working volume	5000mL
Temperature	-90 °C to + 230 °C
Quantity	1

# O Ring, Clamp

## For Glass Reactor



**9260R00006** | **O Ring for DN150**

Material	FKM
Quantity	1



**9220-362-B** | **O Ring for DN150**

Material	FFKM
Quantity	1



**3966-150** | **Clamp**

Material	Stainless steel
Size	DN150
Quantity	1

# Stoppers

## For Reactor Covers



<b>2242-14/23</b>	<b>Flat Head Glass stopper ST14/23</b>
Material	Borosilicate glass
Quantity	1

<b>2242-24/30</b>	<b>Flat Head Glass stopper ST24/30</b>
Material	Borosilicate glass
Quantity	1

<b>2242-29/42</b>	<b>Flat Head Glass stopper ST29/42</b>
Material	Borosilicate glass
Quantity	1



<b>MT51190878</b>	<b>Hex Head Glass stopper ST14/23</b>
Material	Borosilicate glass
Quantity	1



<b>MT30245712</b>	<b>Blanking nut for 1" NPT port</b>
Material	PTFE
Port	1" NPT
Quantity	1

<b>MT30245711</b>	<b>Blanking nut for 3/4" NPT port</b>
Material	PTFE
Port	3/4" NPT
Quantity	1



# Standard Taper Joint Adapters

## For PTFE Covers and Reducing Adapters



<b>MT30215733</b>	<b>Taper joint adapter 3/4" NPT ST24/40</b>
Material	PTFE
Size	Inner Ø ST24/-, height 55 mm, 3/4" NPT
Quantity	1



<b>MT30245674</b>	<b>Taper joint adapter 3/4" NPT ST29/42</b>
Material	PTFE
Size	Inner Ø ST29/-, height 68 mm, 3/4" NPT
Quantity	1

## Adapters

### For Probe Sensors



<b>MT30245680</b>	<b>Compression Fitting 3/4" NPT, Ø 8</b>
Material	PTFE
Size	Ø 8 mm, 3/4" NPT
Quantity	1

<b>MT30245681</b>	<b>Compression Fitting 3/4" NPT, Ø 12</b>
Material	PTFE
Size	Ø 12 mm, 3/4" NPT
Quantity	1

<b>MT5702P00008</b>	<b>Compression Fitting 3/4" NPT, Ø 19</b>
Material	PTFE
Size	Ø 19 mm, 3/4" NPT
Quantity	1

<b>MT30245700</b>	<b>Compression Fitting 3/4" NPT, 3/8"</b>
Material	PTFE
Size	Ø 3/8", 3/4" NPT
Quantity	1

<b>MT5702P00011</b>	<b>Compression Fitting 3/4" NPT, 1/2"</b>
Material	PTFE
Size	Ø 1/2", 3/4" NPT
Quantity	1

# Flush Valve

## Flush Valve with thermometer



<b>3960-01T</b>	<b>Flush Valve, SQG-29/42</b>
Material	Borosilicate glass, PTFE
Size	length 150 mm
Quantity	1



<b>3960-01TT</b>	<b>Flush Valve with thermometer, SQG-29/42</b>
Material	Borosilicate glass, PTFE
Size	length 253 mm
Quantity	1



<b>3960-PTSF</b>	<b>Flush Valve, PTFE Shaft</b>
Material	PTFE
Size	length 149 mm
Quantity	1



<b>3960-PTSFT</b>	<b>Flush Valve with thermometer, PTFE Shaft</b>
Material	PTFE
Size	length 253 mm
Quantity	1



<b>3960-B</b>	<b>Flush Valve, Glass Cover, SQG-29/42</b>
Material	Borosilicate glass
Size	length 130 mm
Quantity	1

# Reflux Condenser



**3442-300W-4L1L**    **Reflux condenser, ST24/40**

Material	Borosilicate glass
Size	ST24/40, height 425 mm
Quantity	1



**3531-4L-V**    **Reflux condenser Manual control, ST24/40**

Material	Borosilicate glass
Size	ST24/40, height 200 mm
Quantity	1



**2402-1L**    **Exhaust Pipe, bended, ST15/25**

Material	Borosilicate glass
Size	ST15/25, height 35 mm
Quantity	1



**2232-14S**    **Reflux condenser Manual control, PTFE Shaft**

Material	PTFE, FFKM
Size	height 70 mm
Quantity	1

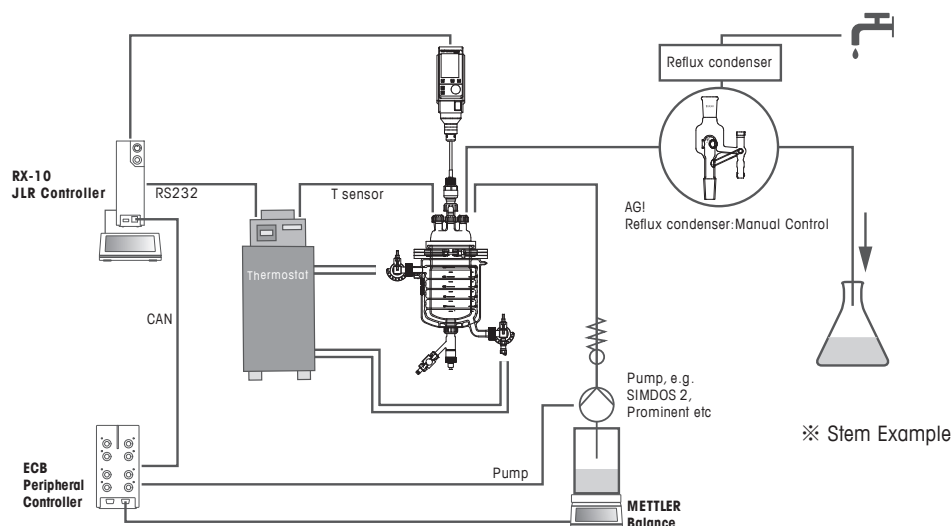



<b>2057-14-HCL</b>	<b>Hose Adaptor</b>
Material	Nozzle: PP, Screw Cap:PBT, O Ring: VMQ
Size	GL14, height 50 mm
Quantity	1

\* 3442-300W-4L1L, 3531-4L-V: Common Parts

## Dosing Adaptor



<b>MT51161834</b>	<b>3-Way Dosing Adapter Set</b>
Material	Borosilicate glass, PBT, PTFE, Silicone rubber
Size	ST14/23-GL14: 3-Way glass adaptor
Quantity	1of each in a set



<b>2304-14/234L</b>	<b>Reducing Adapter ST-14/23 to ST24/40</b>
Material	Borosilicate glass
Size	ST24/40
Quantity	1



<b>MT51190318</b>	<b>Screw cap GL14, closed</b> with PTFE sealing
Material	PBT
Temperature	Max. 200 °C
Quantity	1



# SQG Adapters

## For PTFE Reactor Covers



<b>5702P00003</b>	<b>Compression Screw Fittings, SQG29/42</b>
Material	PTFE
Size	SQG29/42, 1" NPT
Quantity	1

# Universal Stirrer Guide



<http://bit.ly/2AUTzrz>

<b>3341-5L-10</b>	<b>Universal Stirrer Guide, SQG-29/42</b>
Material	PTFE
Size	Ø 10 mm, length 180 mm
Quantity	1



<b>3341-510RP</b>	<b>Universal Stirrer Guide, Lock Nut Set Ø 10</b>
Material	PTFE
Quantity	1



<b>3347-518BS</b>	<b>Universal Stirrer Guide, Bearing Seal Ø 10</b>
Material	PTFE
Quantity	1

# Stand For Glass Reactor



<b>5750000001</b>	<b>Stand: DN150</b>
Material	SS + Epoxy Resin, SUS304
Size	380 mm x 380 mm x 1206 (W, D, H)
Quantity	1



<b>5750E00001</b>	<b>① Overhead Stirrer Motor Support Unit</b>
Material	SS + Epoxy Resin, SUS304
Size	237 mm x 175 mm (W, D)
Quantity	1



<b>5750C00002</b>	<b>② Clamp Unit</b>
Material	SS + Epoxy Resin, SUS304
Size	302 mm x 323 mm (W, D), DN150
Quantity	1



<b>5750A00001</b>	<b>③ Base Unit</b>
Material	SS + Epoxy Resin, SUS304
Size	380 mm x 380 mm x 1206 (W, D, H)
Quantity	1

# Temperature Sensor and Metal Adapter



3381-600	Temperature Sensor
Material	PTFE, Metal filled PTFE
Size	Ø 8 mm, length 660 mm
Quantity	1



9199L00001	Metal Adapter
Material	SUS304, Viton
Size	M16
Quantity	1

# Insulated Flexible Hose



<http://bit.ly/2JQk9ol>

3395161000	Insulated Flexible Hose M16
Operating Temperature	-90 °C to +250 °C
Size	M16, length 1.0 m
Quantity	1

3395161500	Insulated Flexible Hose M16
Operating Temperature	-90 °C to +250 °C
Size	M16, length 1.5 m
Quantity	1

3395162000	Insulated Flexible Hose M16
Operating Temperature	-90 °C to +250 °C
Size	M16, length 2.0 m
Quantity	1

# PTFE Stirrers

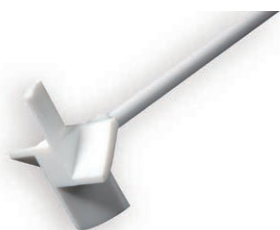

**3365P-10/70/650** | Stirrer Shaft, Pitched Paddle type

Material	PTFE, Steel
Size	Ø 10 mm, length 600 mm
Quantity	1



**3360P-10/70/600** | Stirrer Shaft, Anchor type

Material	PTFE, Steel
Size	Ø 10 mm, length 600 mm
Quantity	1



**3364P-10/70/650** | Stirrer Shaft, Retreat curve type

Material	PTFE, Steel
Size	Ø 10 mm, length 600 mm
Quantity	1



**3353-10/90/650** | Stirrer Shaft, HB type

Material	PTFE, Steel
Size	Ø 10 mm, length 650 mm
Quantity	1



<http://bit.ly/2AVpx72>



# AGI Reaction Unit controlled by RX-10 Hydrogeneration Unit



## Pressure Reactor

## Hydrogeneration Unit

Vessel Capacity: 500 mL, 1000 mL, 1500 mL

Vessel Type: DN 80

Operating Pressure : Full Vacuum to +10 bar G (+1.0 MPa)

Operating Jacket Pressure: Up to +0.5 bar G (+0.05 MPa)

Operating Temperature : -20 °C to +220 °C

$\Delta T$ : 60 °C

Wetted Parts: borosilicate glass 3.3, PTFE, SS316, and perfluoro(FFKM)

This system does not include overhead stirrer, circulator and chiller.

Please contact us about customized systems.

# Hydrogeneration Unit

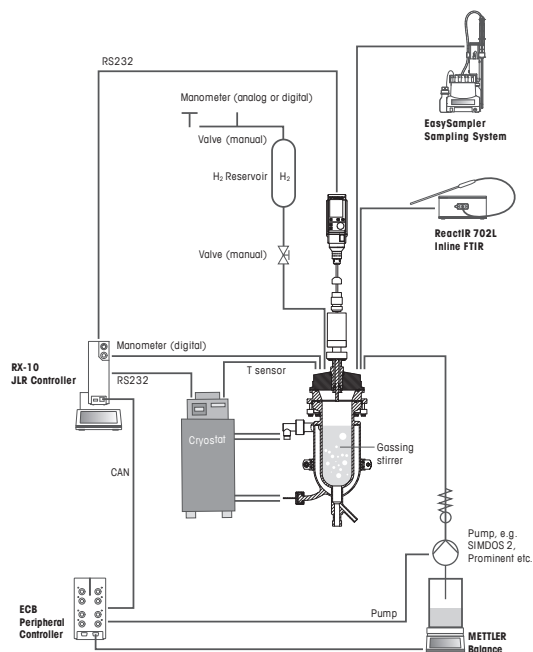

Hydrogeneration Unit System Example

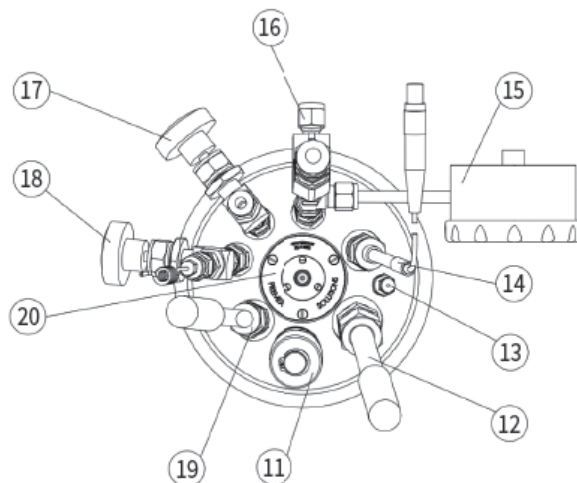

Reaction Unit : Top

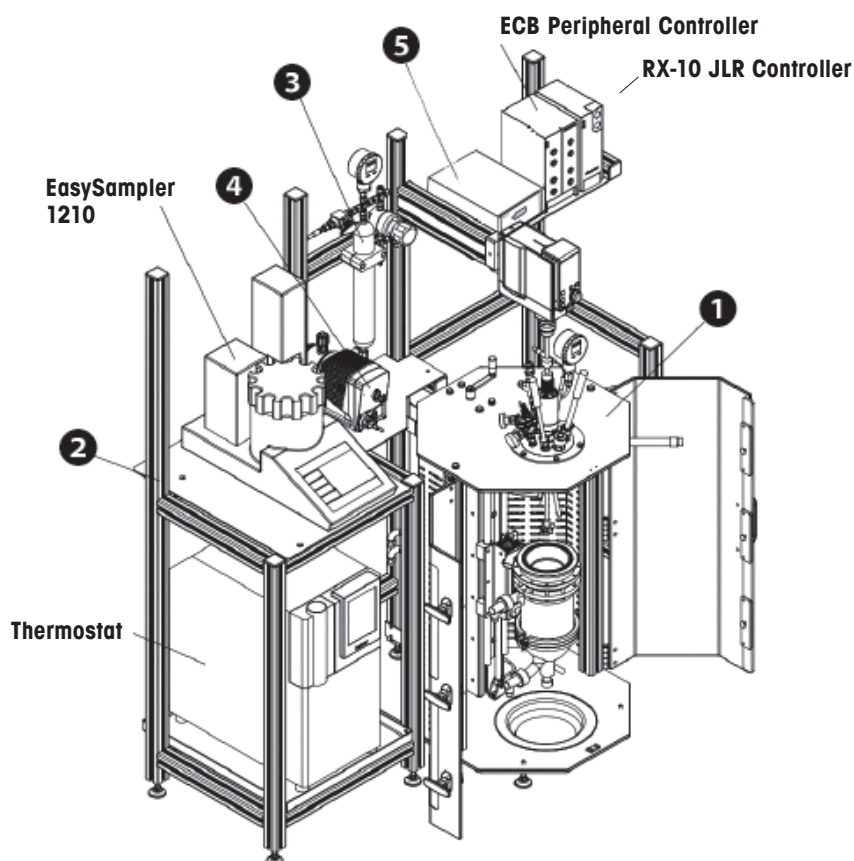

Hydrogeneration Unit

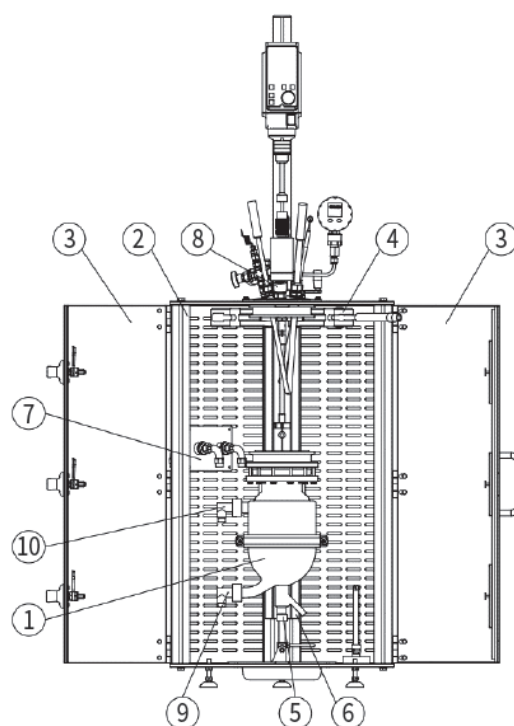

Reaction Unit

Order Number	Product Description	Quantity
<b>5501-500</b>	500 mL Reaction Unit	1
<b>5501-1000</b>	1000 mL Reaction Unit	1
<b>5501-1500</b>	1500 mL Reaction Unit	1

### Reaction Unit consisting of

Number	Order Number	Product Description	500 mL	1000 mL	1500 mL	Quantity
①	<b>5507-500</b>	500mL Pressure Reactor 10 bar Double Wall DN80	●			1
	<b>5507-1000</b>	1000mL Pressure Reactor 10 bar Double Wall DN80		●		1
	<b>5507-1500</b>	1500mL Pressure Reactor 10 bar Double Wall DN80			●	1
②		Frame	●	●	●	1
③		Door	●	●	●	1
④		Quick closure	●	●	●	1
⑤		Bottom valve	●	●	●	1
⑥		Lifting device	●	●	●	1
⑦		Connection to thermostate	●	●	●	1
⑧		Autoclave lid	●	●	●	1
⑨		Inlet thermo liquid	●	●	●	1
⑩		Outlet thermo liquid	●	●	●	1
⑪		Filler plug	●	●	●	1
⑫		Connection for 1/2" probe	●	●	●	1
⑬		1/8" connection for liquid inlet	●	●	●	1
⑭		Thermocouple 1 x Pt100	●	●	●	1
⑮		Pressure transmitter	●	●	●	1
⑯		Relief valve and connection to pressure transmitter	●	●	●	1
⑰		Valve for pressure release	●	●	●	1
⑱		Valve for gas inlet	●	●	●	1
⑲		Connection for 3/8" probe	●	●	●	1
⑳		Magnetic stirrer head	●	●	●	1

\* Overhead stirrer motor is not included

### Hydrogeneration Unit consisting of

Number	Order Number	Product Description	500 mL	1000 mL	1500 mL	Quantity
①	<b>5501-500</b>	500 mL Reaction Unit	●			1
	<b>5501-1000</b>	1000 mL Reaction Unit		●		1
	<b>5501-1500</b>	1500 mL Reaction Unit			●	1
②		Frame for equipment	●	●	●	1
③		Gas uptake system	●	●	●	1
④		Prominent pump Beta b	●	●	●	1

### RX-10

Order Number	Product Description	Quantity	Page
<b>30208790</b>	RX-10 units	1	35

### ECB

Order Number	Product Description	Quantity	Page
<b>30212440</b>	ECB set	1	39

### EasySampler 1210

Order Number	Product Description	Quantity	Page
<b>30083901</b>	EasySampler system	1	38

### Thermostate — Huber Petite Fleur

Order Number	Product Description	Quantity	Page
<b>1030.0001.01</b>	Huber Petite Fleur with Pilot ONE	1	33

### ProMinent pump

Order Number	Product Description	Quantity	Page
<b>51190994</b>	ProMinent pump BT4b 1601 TTT	1	41

Order Number	Product Description	Quantity	Page
<b>51191739</b>	ProMinent pump BT4b 1601 SST	1	41

### Connecting Sensors and Analytics

Number	Order Number	Product Description	Quantity	Page
⑤	<b>30456495</b>	ReactIR 702L	1	37

# Pressure Reactor



**5507-500** | 500mL Pressure Reactor 10 bar  
Double Wall DN80

Material	Borosilicate glass 3.3
Nominal Volume	500 mL
Working volume	200 mL
Temperature	-20 °C to +220 °C
$\Delta T$	60 °C
Quantity	1



**5507-1000** | 1000mL Pressure Reactor 10 bar  
Double Wall DN80

Material	Borosilicate glass 3.3
Nominal Volume	1000 mL
Working volume	700 mL
Temperature	-20 °C to +220 °C
$\Delta T$	60 °C
Quantity	1



**5507-1500** | 1500mL Pressure Reactor 10 bar  
Double Wall DN80

Material	Borosilicate glass 3.3
Nominal Volume	1500 mL
Working volume	1000 mL
Temperature	-20 °C to +220 °C
$\Delta T$	60 °C
Quantity	1



■ Nominal Volume  
■ Working Volume

# O Ring, Metal Adapter, Thermostat For Pressure Reactor



**9220-349** | **O Ring for DN80**

Material	FFKM
Quantity	1



**9199L00001** | **Metal Adapter**

Material	SUS304, Viton
Size	M16
Quantity	1



**1030.0001.01** | **Huber Petite Fleur with Pilot ONE**

Temperature Range	-40...200 °C
Temperature Stability	±0,01 °C
Display Resolution	0,01 °C
Dimensions (W x D x H)	260 x 450 x 504 mm
Weight	45 kg
Quantity	1



# Connecting Sensors, Dosing Devices and Analytics



AGI Reaction Unit

RX-10 main unit

Sensors and  
Controlled Dosing



ECB main unit

Dosing



SP-50



KNF SIMDOS 02  
FT.18 RC-X Series

pH Meter & Sensor



SevenExcellence S400-Basic



SevenExcellence pH/mV module



InLab Reach 425

Particle Characterization

In situ Spectroscopy

Sampling

Analytical Balances



Particle View V19



Particle Track G400



ReactIR 702L



ReactRaman 785



Easy Sampler 1210



ML6001T/A00

# RX-10™

## Reactor Control and Data Capture

**RX-10 provides an interface connecting any types and volumes of jacketed reactors to cryostats, thermostats, stirrer motors, and sensors. This allows researchers to precisely control and monitor chemical reactions and processes in the lab or kilo lab environment**



### 30208790

#### **RX-10 with 1 m touchscreen cable**

Touchscreen-based control unit to automate and monitor jacketed lab reactors. Third party thermostats, stirrers and sensors can be connected via plug-and-play interfaces.

### 30217050

#### **RX-10 with 3 m touchscreen cable**

Please contact us about Automated Lab Reactor Control.

[www.mt.com/SynthesisWorkstations](http://www.mt.com/SynthesisWorkstations)

### **RX-10 units consisting of**

Order Number	30208790 RX-10 Unit	30217050 RX-10 Unit	Quantity	Page
30303438	RX-10 main unit		1	36
51161883	Touchscreen 7", 1 m cable		1	36
30303580		Touchscreen 7", 3 m cable	1	36
30281496	Lab bar holder		1	36
30090591	Power supply		1	36
	USB memory stick		1	
	iControl CD		1	
	iControl Office License		1	
30281497	Thermostat/stirrer RS232 cable set, 6 cables		1	36
	RX-10 Quick Start Guide		1	

**Note:** Large image may not show all parts in the sets.



<b>30303438</b>	<b>RX-10 main unit</b>
Size	70 mm x 152 mm x 215 mm (w, d, h)
Weight	2.88 kg, including touchscreen
Quantity	1



<b>51161883</b>	<b>TFT touchscreen 7", 1 m cable</b>
Material	PA, aluminium
Size	195 mm x 135 mm x 60 mm (w, d, h)
Quantity	1



<b>30281496</b>	<b>Lab bar holder</b>
Material	aluminium, stainless steel
Size	134.75 mm x 35.5 mm x 30 mm (l, w, h)
Quantity	1



<b>30281497</b>	<b>Thermostat/stirrer RS232 cable set</b> dedicated and color coded
Size	Length 2.9 m each
Quantity	6 pcs per set



<b>30090591</b>	<b>Power supply for CAN bus devices</b> required if additional CAN devices are connected
Quantity	1



<http://bit.ly/2x4X1wD>

## Optional Accessories For RX-10



<b>30260369</b>	<b>Emergency button</b>
Size	125 mm x 80 mm x 95 mm (l, w, h)
Quantity	1

<b>30267163</b>	<b>SmartConnect Pt100 cable with loose ends</b> for Pt100 sensors
Quantity	1

<b>30267165</b>	<b>SmartConnect sensor cable with loose ends</b> for Pt100 and other sensors
Quantity	1

<b>30254779</b>	<b>SmartConnect LE03/EV-120 cable</b> for pressure measurement
Quantity	1

# Sampling, inline Analytics and Measurement



<http://bit.ly/2x1qcRx>

<b>14000031</b>	<b>Particle View V19</b>
Probe Wetted Material	C22 Alloy
Size	Ø 19 mm, Wetted length 400 mm
Quantity	1

**ParticleView V19** with PVM (Particle Vision and Measurement) technology is a probe-based video microscope that visualizes particles and particle mechanisms as they exist in process.



<http://bit.ly/2N4LJnf>

<b>14420890</b>	<b>Particle Track G400</b>
Probe Wetted Material	C22 Alloy
Size	Ø 19 mm, Wetted length 400 mm
Quantity	1

**ParticleTrack G400** with FBRM Technology is a probe-based instrument that is inserted directly into laboratory reactors to track changing particle size and count in real time at full process concentrations.



<http://bit.ly/2AHo30h>

<b>30456495</b>	<b>ReactIR 702L</b>
Probe Wetted Material	C-22, Gold, PTFE, Diamond, Silicon
Size	Ø 9.5 mm, Probe length 457 mm
Quantity	1

**ReactIR 702L** is a real-time, in situ mid-infrared based system designed to study reaction progression and provide specific information about reaction initiation, conversion, intermediates and endpoint.



<http://bit.ly/2OU3S74>

<b>304725451</b>	<b>ReactRaman 785</b>
Probe Wetted Material	C-276, Sapphire, Gold
Size	Ø 12.7 mm, Wetted length 260 mm
Quantity	1



<http://bit.ly/2x6zpb0>

30083901	Easy Sampler 1210
Material	Housing: Polypropylene PP 30% Talcum Tubing: PTFE Needle: Stainless steel Valve: Ceramic Pump: Ceramic, PTFE
Size	310 mm x 500 mm x 465 mm, Ø 9.5 mm
Quantity	1

**The EasySampler 1210** offers unattended and representative sampling for a wide range of chemical reactions.



<http://bit.ly/2AnitA5>

30243431	ML6001T/A00
Material	Maximum Capacity: 6,200 g Readability: 0.1 g Interfaces: RS232, USB Device, USB Host AdjustmentInternal / FACT Legal for Trade: Yes Repeatability (typical): 0.06 g Settling Time: 1 s Repeatability: 0.1 g
Weighing pan size	170 x 190 mm
Quantity	1



# ECB™ – Easy Control Box

## Sensors and Controlled Dosing



### 30212440

#### ECB

Adds capabilities for additional sensors (pH, pressure, turbidity, massflow etc.) and controlled dosing to EasyMax, OptiMax and RX-10. Usage either through local touchscreen or iControl PC software.

#### ECB set consisting of

Order Number	Product Description	Quantity	Page
	ECB main unit	1	40
51191988	CAN cable 1.0 m	1	40
30281496	Lab Bar Holder	1	40



	ECB main unit
Required main reactor device to operate the ECB	EasyMax, OptiMax or RX-10 through local touchscreen or iControl PC software
Size	210 mm x 152 mm x 297 mm (w, d, h)
Weight	3.4 kg
Quantity	1



	30281496 Lab bar holder
Material	aluminium, stainless steel
Size	134.75 mm x 35.5 mm x 30 mm (l, w, h)
Quantity	1



	51191988 CAN cable 1.0 m
Size	Length 1.0 m
Quantity	1



<http://bit.ly/2N4MM6E>

## Optional Accessories



	30090591 Power supply for CAN bus devices required if additional CAN devices are connected
Quantity	1



	30264936 CAN cable 3.0 m
Size	Length 3.0 m
Quantity	1

# Controlled Dosing

## With the Easy Control Box (ECB)



<b>30335504</b>	<b>KNF SIMDOS 02 FT.18 RC-X</b> 30 µL – 20 mL/min, max pressure 6 bar
Material	Pump head: PTFE, Diaphragm: PTFE covered Valves: FFKM Kalrez, Filter: PEEK
Quantity	1



<b>30254805</b>	<b>SmartConnect KNF SIMDOS control cable</b>
Size	Length 2.0 m
Quantity	1

<b>30335503</b>	<b>KNF SIMDOS 10 FT.18 RC-X</b> 1 mL – 100 mL/min, max pressure 6 bar
Material	Pump head: PTFE, Diaphragm: PTFE covered Valves: FFKM Kalrez, Filter: PEEK
Quantity	1



<b>51190994</b>	<b>ProMinent pump BT4b 1601 TTT</b> Capacity at 8 bar, backpressure: 23 mL/min, suction/discharge valves: PTFE with carbon
Material	Seals: PTFE, diaphragm: PTFE valve balls: ceramic
Quantity	1



<b>30254804</b>	<b>SmartConnect ProMinent control cable</b>
Size	Length 2.0 m
Quantity	1

<b>51191739</b>	<b>ProMinent pump BT4b 1601 SST</b> Capacity at 8 bar, backpressure: 23 mL/min, suction/discharge valves: stainless steel
Material	Seals: PTFE, diaphragm: PTFE valve balls: ceramic
Quantity	1

# Dosing Unit SP-50 Set

\* The number beginning with "MT" can be purchased at AGI



**51161770**

## Dosing unit SP-50 set

This unit allows the dosing of one reagent in two reactors completely independent and in parallel via touchscreen or PC software.

Only available in the set.

## Dosing unit SP-50 set consisting of

Order Number	Product Description	Quantity	Page
	Dosing Unit SP-50, only available in the set	1	43
<b>51191988</b>	CAN cable 100 cm	1	43
<b>51191306</b>	PTFE dosing tube Ø 3.2 mm	3	43
<b>51191304</b>	PTFE dosing tube Ø 1.6 mm	2	43
<b>MT51191514</b>	Ferrule for tubing and sensors of outer Ø 3.2 mm, 4 pcs in a set	1	43
<b>MT51191515</b>	Nut for UNF 1/4-28 threads, outer Ø max. 3.2 mm , 4 pcs in a set	1	43
<b>MT51191202</b>	Ferrule for tubing and sensors of outer Ø 1.6 mm, 4 pcs in a set	1	43
<b>MT51191203</b>	Nut for UNF 1/4-28 threads, outer Ø max. 1.6 mm, 4 pcs in a set	1	43
<b>MT51191204</b>	Plug for UNF 1/4-28 threads, 4 pcs in a set	1	43
<b>MT51191267</b>	Glass adapter ST14/23-GL14	2	44
<b>MT51192208</b>	Glass adapter ST19/26-GL14	1	44
<b>MT51190318</b>	Screw cap GL14, closed	3	44
<b>MT51191170</b>	Silicone rubber seal (septum)	10	44
<b>MT51190317</b>	Screw cap GL14, with aperture	3	44
<b>MT51103947</b>	Silicone rubber sealing ring for screw cap GL14, aperture 6 mm	1	44
<b>MT51191591</b>	Bottle GL45 250 mL	1	44
<b>MT51191972</b>	Distributor cap GL45 2 x GL14	1	44
<b>MT51161558</b>	Adapter GL14-UNF with 1 UNF 1/4-28 port	3	44
<b>MT51191687</b>	Assorted heat-shrink tubings, 8 pcs in a set	1	44

**Note:** Large image may not show all parts in the set.



	<b>Dosing unit SP-50</b>
Size	100 mm x 150 mm x 296 mm (w, d, h)
Quantity	1

**Note:** Only available in the set



	<b>51191988</b>	<b>CAN cable 100 cm</b>
Size		Length 100 cm
Quantity		1



	<b>51191306</b>	<b>PTFE dosing tube Ø 3.2 mm</b>
Material		PTFE
Size		Ø 3.2 mm, length 2.5 m
Quantity		1



	<b>51191304</b>	<b>PTFE dosing tube Ø 1.6 mm</b>
Material		PTFE
Size		Ø 1.6 mm, length 2.5 m
Quantity		1



	<b>MT51191514</b>	<b>Ferrule for tubing and sensors of outer Ø 3.2 mm</b>
Material		ETFE
Size		Inner Ø max. 3.2 mm
Quantity		4 pcs in a set



	<b>MT51191515</b>	<b>Nut for UNF 1/4-28 threads</b>
Material		ETFE
Size		Inner Ø max. 3.2 mm
Quantity		4 pcs in a set



	<b>MT51191202</b>	<b>Ferrule for tubing and sensors of outer Ø 1.6 mm</b>
Material		ETFE
Size		Inner Ø max. 1.6 mm
Quantity		4 pcs in a set



	<b>MT51191203</b>	<b>Nut for UNF 1/4-28 threads</b>
Material		ETFE
Size		Inner Ø max. 1.6 mm
Quantity		4 pcs in a set



	<b>MT51191204</b>	<b>Plug for UNF 1/4-28 threads</b>
Material		ETFE
Size		Outer Ø max. 1.6 mm
Quantity		4 pcs in a set



<b>MT51191267</b>	<b>Glass adapter ST14/23-GL14</b>
Material	Borosilicate glass
Size	Height 54 mm
Quantity	1



<b>MT51192208</b>	<b>Glass adapter ST19/26-GL14</b>
Material	Borosilicate glass
Size	Height 50 mm
Quantity	1



<b>MT51190318</b>	<b>Screw cap GL14, closed with PTFE sealing</b>
Material	PBT
Temperature	Max. 200 °C
Quantity	1



<b>MT51191170</b>	<b>Silicone rubber seal (septum) for screw cap GL14</b>
Material	Silicone rubber VQM
Size	Ø 12 mm, thickness 2 mm
Quantity	1



<b>MT51190317</b>	<b>Screw cap GL14, with aperture</b>
Material	PBT
Temperature	Max. 200 °C
Aperture	Ø 9.5 mm
Quantity	1



<b>MT51103947</b>	<b>Silicone rubber sealing ring with vulcanized-on PTFE washers for screw cap GL14</b>
Material	Silicone rubber VQM, PTFE-coated
Size	Ø 12 mm, aperture 6 mm
Quantity	1

Can also be used for Ø 1/4" 6.35 mm inserts



<b>MT51191591</b>	<b>Bottle GL45 250 mL with cap</b>
Material	Glass, PP
Quantity	1



<b>MT51191972</b>	<b>Distributor cap GL45 2 x GL14</b>
Material	PP
Quantity	1



<b>MT51161558</b>	<b>Adapter GL14-UNF with 1 UNF 1/4-28 port for screw cap GL14</b>
Material	PTFE GF25
Size	Inner Ø 3.4 mm, 20 mm
Quantity	1



<b>MT51191687</b>	<b>Assorted heat-shrink tubings 8 pcs in a set</b>
Material	Polyolefin
Quantity	1



# Dosing Unit SP-50 Syringes

## 1 mL, 10 mL, 25 mL, and 50 mL

\* The number beginning with "MT" can be purchased at AGI



<b>MT51191793</b>	<b>Syringe 1 mL</b>
Material	Glass, PTFE, metal
Volume	1 mL
Quantity	1



<b>MT51191792</b>	<b>Syringe 10 mL</b>
Material	Glass, PTFE, metal
Volume	10 mL
Quantity	1



<b>MT51191794</b>	<b>Syringe 25 mL</b>
Material	Glass, PTFE, metal
Volume	25 mL
Quantity	1



<b>MT51191987</b>	<b>Syringe 50 mL</b>
Material	Glass, PTFE, metal
Volume	50 mL
Quantity	1

## Optional Accessory



<b>30090591</b>	<b>Power supply for CAN bus devices</b> required if additional CAN devices are connected
Quantity	1

# SevenExcellence™ for RX-10 pH/mV Measurement Equipment

\* The number beginning with "MT" can be purchased at AGI



## SevenExcellence pH/mV meter system for EasyMax or RX-10

pH measurement without any additional control box. Just connect the SevenExcellence to the EasyMax/RX-10 instrument. EasyMax/RX-10 will log pH data and show them online on the touchscreen.

### SevenExcellence pH measurement recommended items

Order Number	Product Description	Quantity	Page
30046240	SevenExcellence S400-Basic including one pH/mV module	1	47
30034472	SevenExcellence pH/mV module	1	47
30248120	InLab Reach 425 (Ø 12 mm, length 425 mm)	1	47
51191926	USB A-B cable (connection cable to EasyMax/RX-10)	1	47
30281915	BNC to S7 connector cable, 1.2 m	1	47
30281916	BNC to S7 connector cable, 3.0 m	1	47
30281917	BNC to S7 connector cable, 5.0 m	1	47
MT51161852	ST14 adapter set for probes, Ø 1.6 mm to 8 mm	1	47

**Note:** Large image may not show all parts of the SevenExcellence S400-Basic Instrument.



<b>30046240</b>	<b>SevenExcellence S400-Basic</b> with one pH/mV expansion module
Size	235 mm x 188 mm x 75 mm (w, d, h)
Quantity	1



<b>30034472</b>	<b>SevenExcellence pH/mV module</b> for analog sensors only (no ISM)
Quantity	1



<b>30248120</b>	<b>InLab Reach 425</b> for 3000 mL, 5000mL reactors
Temperature	0 °C to 100 °C
Size	Ø 12 mm, length 425 mm, electrode head S7
Quantity	1



<b>MT51161852</b>	<b>ST14 adapter set for Ø 1.6 mm to 8 mm</b> to suit pH electrodes into reactor covers
Material	Glass, PBT, PTFE, silicone rubber
Quantity	1 of each in a set

**Note:** See Page 97 for details



<b>30281915</b>	<b>BNC cable, 1.2 m</b> to connect pH electrode with S7 head to SevenExcellence pH electrode
Size	Length 1.2 m
Quantity	1



<b>51191926</b>	<b>USB A-B cable</b> for data transfer from SevenExcellence to EasyMax/RX-10
Size	Length 3.0 m
Quantity	1

<b>30281916</b>	<b>BNC cable, 3.0 m</b>
Size	Length 3.0 m
Quantity	1

<b>30281917</b>	<b>BNC cable, 5.0 m</b>
Size	Length 5.0 m
Quantity	1



<http://bit.ly/2x1UROx>

# iControl™ Software For RX-10

The software for experiment preparation, instrument control and data evaluation

- iControl for single or multiple instruments
- iControl for Office
- iCare software maintenance



**iControl** provides the maximum amount of information from a single experiment. It uses a simple-to-operate user interface enabling EasyMax, OptiMax, and RX-10 to be operated by either the PC software or in combination with the touchscreen. iControl enables scientists to gain a comprehensive understanding of the chemical reaction under study. The combination of reactor data with information from METTLER TOLEDO analytical tools helps chemists in research and development reach appropriate conclusions from each experiment, enabling them to make better decisions and complete projects faster.

## iControl Software for EasyMax, OptiMax, and RX-10

Order Number	License type	Description
51161893	iControl Single Instrument License	Software license for experiment preparation, control and data evaluation for one instrument
51161894	iControl Multiple Instrument Option	Software license for experiment preparation, control and data evaluation for up to three instruments
51162613	iControl Office License	Software license for experiment preparation and experiment evaluation
51162629	iCare for iControl Instrument	Software maintenance for instrument license



<http://bit.ly/2x3xpjQ>

# iC Data Center™

## Capture, Prepare, Share

**iC Data Center acts as the data link between touchscreens, iControl and iC software applications. It makes data handling simple thanks to the following key functionalities:**

- **Automated saving of experimental data**
- **Automated preparation of data files and reports**
- **Easy data sharing with the help of automatic email notifications**
- **Monitor and optimize instrument usage with help of an utilization dashboard**

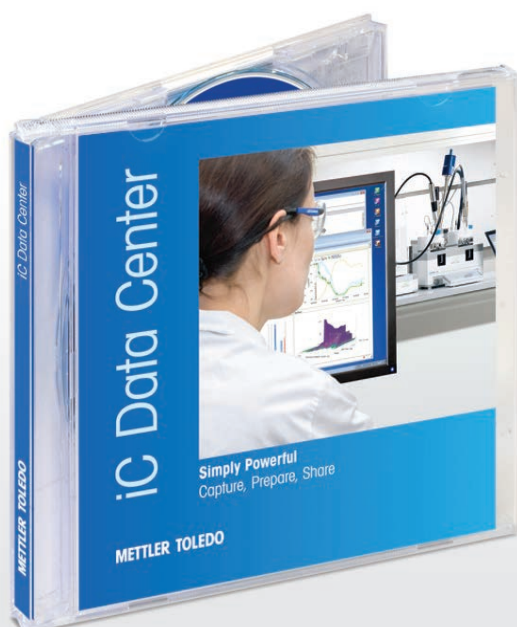

An estimated 85% of lab data is lost because it is not transferred from lab instruments or is not recorded at all. iC Data Center makes day-to-day work significantly easier for researchers and their colleagues by ensuring all experiment data is automatically captured from the local instruments, prepared into useful formats, and shared on a central file store.

With an easy-to-use web based interface for configuration and on-going monitoring of the lab, iC Data Center is a powerful tool that improves productivity for the researcher while facilitating knowledge management for the organization.



<http://bit.ly/2N76b6G>



**100 L**  
Available  
(Double Wall)

### Reaction Unit



[ Lab ] Vessel Capacity : 300 mL, 500 mL, 1 L, 2 L, 3 L, 5 L  
[ Plant ] Vessel Capacity : 10 L, 20 L, 30 L



**100 L**  
Available

### Filter Reactor



[ Lab ] Vessel Capacity : 1 L, 2 L, 3 L, 5 L  
[ Plant ] Vessel Capacity : 10 L, 20 L, 30 L



### Short Path Evaporator



Evaporation Surface Area : 0.05 m<sup>2</sup> (DN60), 0.1 m<sup>2</sup> (DN100)



World Largest  
**200 L**

### Rotary Evaporator



Vessel Capacity : 20 L, 30 L, 50 L, 100 L, 200 L





Max.  
**2 bar G**

### Nutsche Filter



[ Lab ] Vessel Capacity : 1 L, 2 L, 3 L, 5 L (Max. 2 bar G)  
[ Plant ] Vessel Capacity : 10 L, 20 L, 30 L (Max. 1.5 bar G)



Max.  
**1.5 m<sup>2</sup>**  
Evaporation  
Surface Area

### Thin Film Evaporator



Evaporation Surface Area : 0.05 m<sup>2</sup> (DN60), 0.1 m<sup>2</sup> (DN100)

## Customized Configurations are also available!

Together we can work to find the perfect solution to suit your application requirements.  
Please contact us about customized systems.



### About Asahi Glassplant Inc.

Working with glass for over 65 years, we have developed unique and innovative technology, which optimize the distinct characteristics of glass.

Such technology enables us to offer the largest variation from small scale glassware to plant scale glass apparatus and materialize the wish list of researchers and chemical engineers.

[www.agi.co.jp](http://www.agi.co.jp)

**AG!**  
Asahi Glassplant Inc.

---

✉ Contact

[www.mt-agi.com](http://www.mt-agi.com)



**AG!**  
Asahi Glassplant Inc.

Asahi Glassplant Inc.

1978 Takahama, Arao, Kumamoto, 864-0025 JAPAN

Tel : +81 968 68 2121 Fax: +81 968 68 2125

URL : [www.agi.co.jp](http://www.agi.co.jp) E-mail : [info@agi.co.jp](mailto:info@agi.co.jp)